

**^ZIMUT**

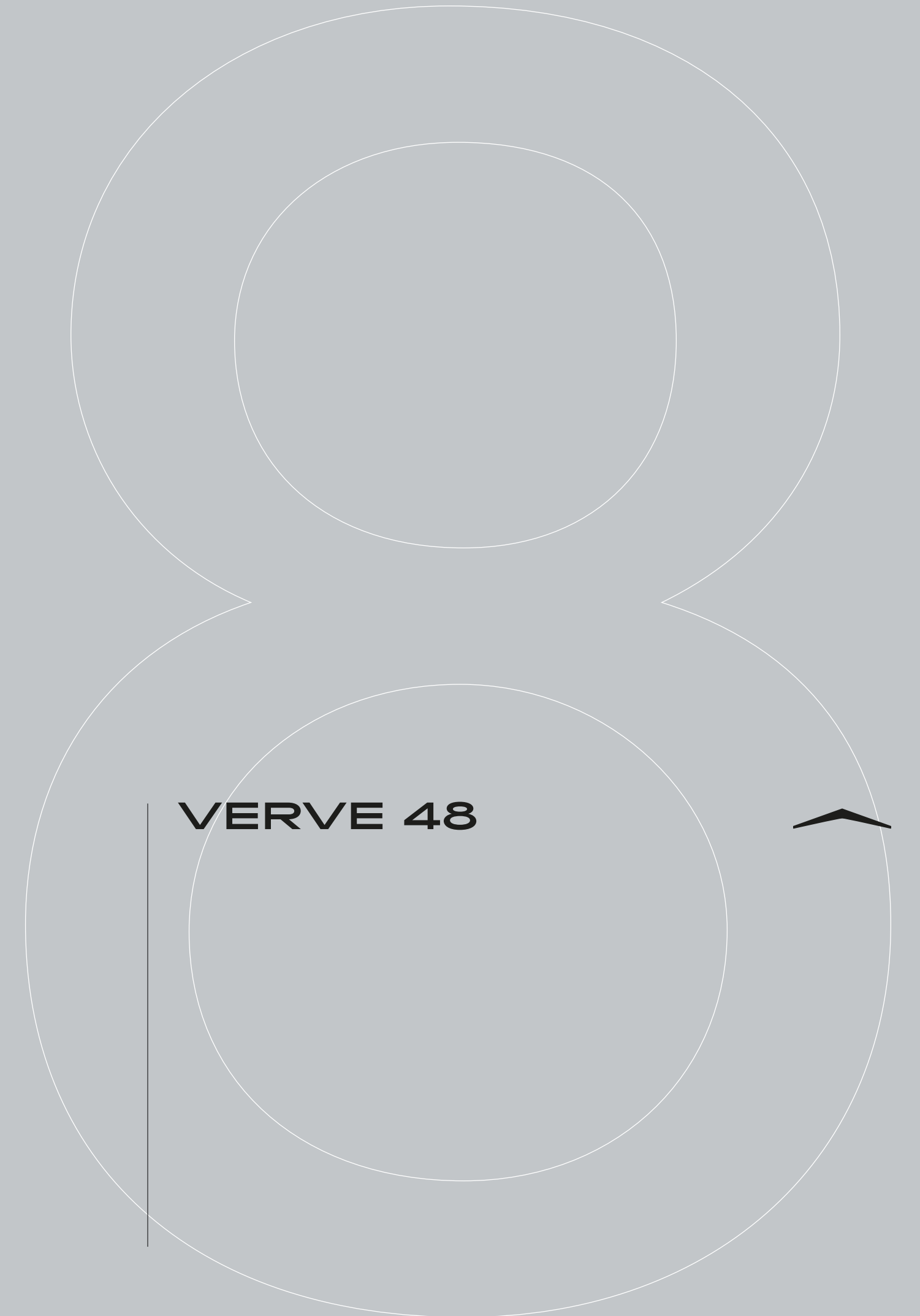

# INDEX

01	THE DESIGN & LIFESTYLE ON BOARD	P04
02	HER MAIN TECHNICAL FEATURES	P25
03	VERVE 48 SPEC SHEET	P30
04	THE VERVE SERIES	P35
05	ABOUT AZIMUT	P37

A one-of-a-kind beauty, enrapturing, that steals your breath away, leaving you speechless. An extraordinary idea as the only possible pathway, to get to where you want, to explore, to go beyond.

The freedom of embracing the unknown, that you know you'll love as a part of your very own story. A thought that provokes your mind and then inspires you to aim for the impossible, making mistakes, yet being brave.

A magic je ne sais quoi that enchants and intrigues you, moving you to feel more and to sense uniqueness.

The choice to risk it all, the one that makes you go for it, to impress yourself and all those who are worth it.

Welcome to Azimut.

AZIMUT.  
DARE TO AMAZE.





01

# THE DESIGN & LIFESTYLE ON BOARD



# VERVE 48

## THE PURSUIT OF ADRENALINE

A phenomenon of performance and the sea born of immersive DNA, the Verve 48 favors the most authentic emotions and superior comfort. With the power to travel over the water up to 50 knots, this single sensational yacht with outboard motors unites speed and agility, becoming the optimal choice for those who love fluid and frequent movements, and want to feel at one with the sea. A statement of powerful design, this vessel full of character represents pure innovation: welcome weekender.

Push further with the Verve 48.









Welcome aboard, ladies and gentlemen.

Let us begin the tour.







# DESIGNED TO THRILL





The asymmetrical split-level layout of the bow is designed to maximize comfort and keep contact with the sea. Up top is an ample, cushioned sunbathing area while just below is a versatile al fresco lounge & dining zone with a six-person table embraced by an inviting C-shaped sofa.









# A PERFECT FUSION OF FUN AND FUNCTIONALITY

The cockpit is the open heart of the sport weekender, expanded onto a fold-down platform just over the waves on the port side with a retractable ladder. She is designed for functionality, accommodating a wide range of uses in comfort with more transforming pieces, like the full-size table which disappears into the floor to clear space between meals and the deployable TV for al fresco viewing parties. The complete kitchen island is ready to serve gatherings of any nature with a wet bar, fridge, ice maker, barbecue, hot plate and sink.





# IMMERSE YOURSELF IN A BRAND NEW CONCEPT OF SEA LIVING





At half height, the table can be covered with cushions to turn the sofas into a sunbed. For dining with the table at full height, a cover is placed over the tabletop for a clean and classy setting.





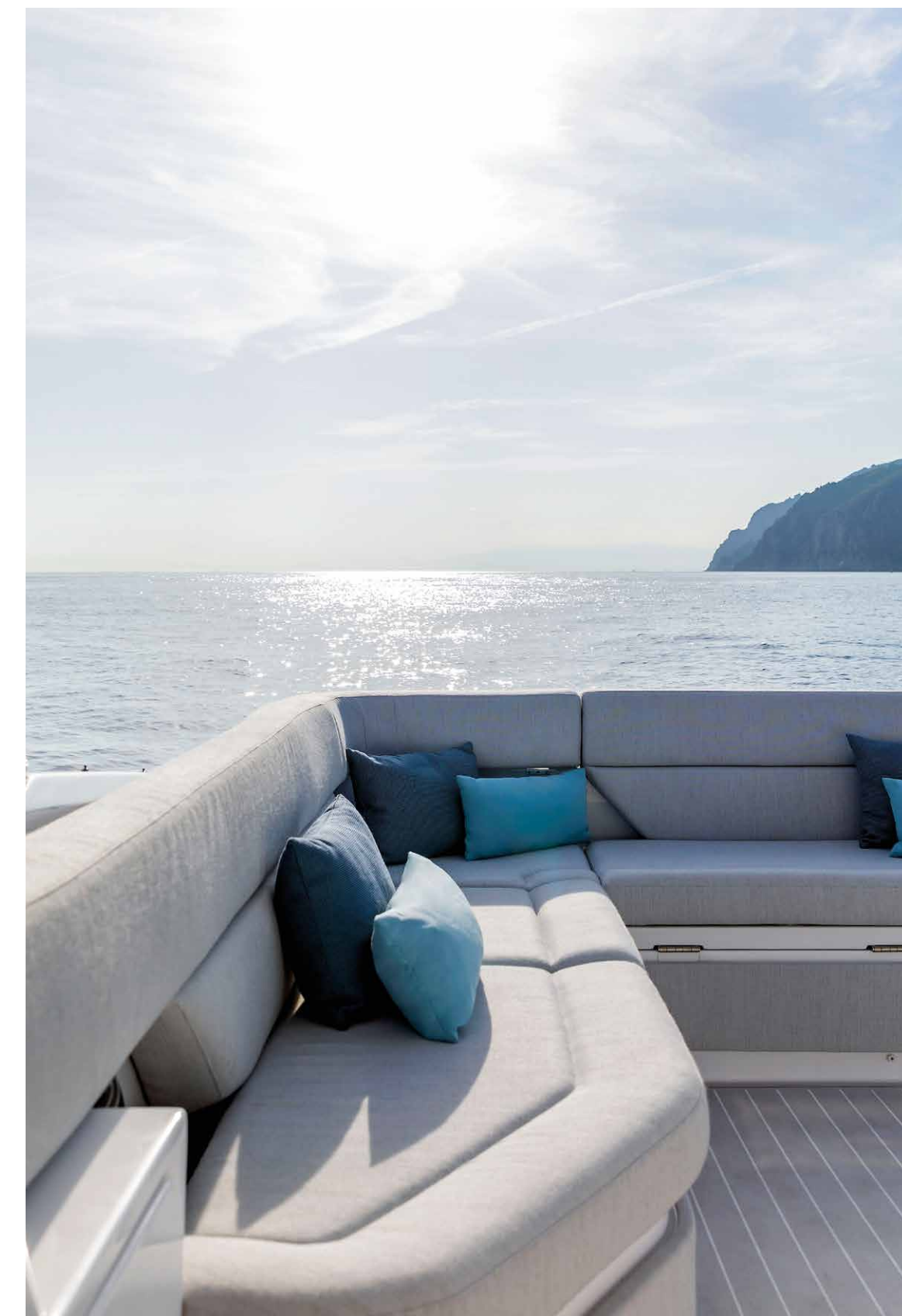





VERVE 48



AZIMUT YACHTS

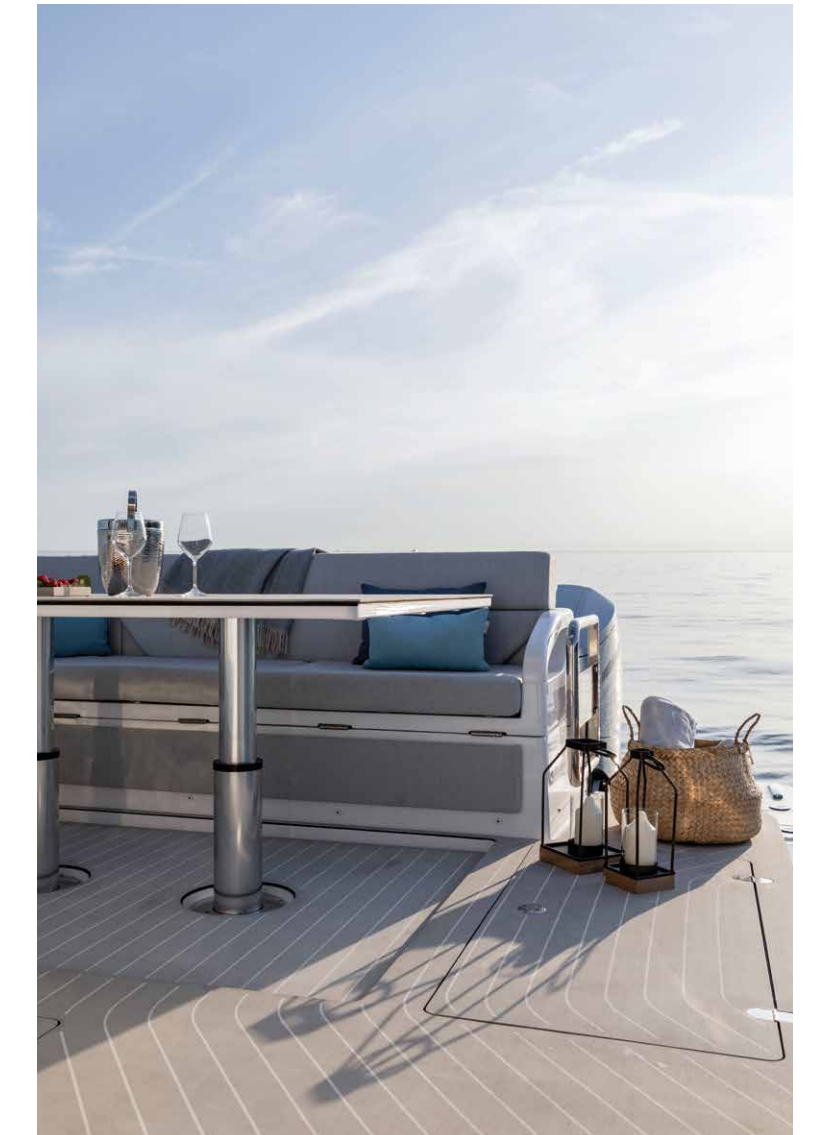





# POWER, DESIGN AND COMFORT



[ The modern, stylish helm station is based on a Plug&Play layout concept featuring clean, stark lines and a high-tech approach that uses led lighting to stunning effect. ]











Sophisticated yet cosy and welcoming, interiors are a testament to the meticulous attention to detail that has gone into creating the perfect cozy of comfort, style and versatility.





# DESIGN TO WELCOME







The dinette, located on the beam amidships, can be transformed into a spacious relaxation zone with a large L-shape divan and a high-low table that can be converted into a double bed.



# YOUR COZY RESIDENCE ON THE SEA





[ The second cabin surprises guests with the unexpected comfort of flush twin beds and a naturally lit, easily accessible corridor. ]

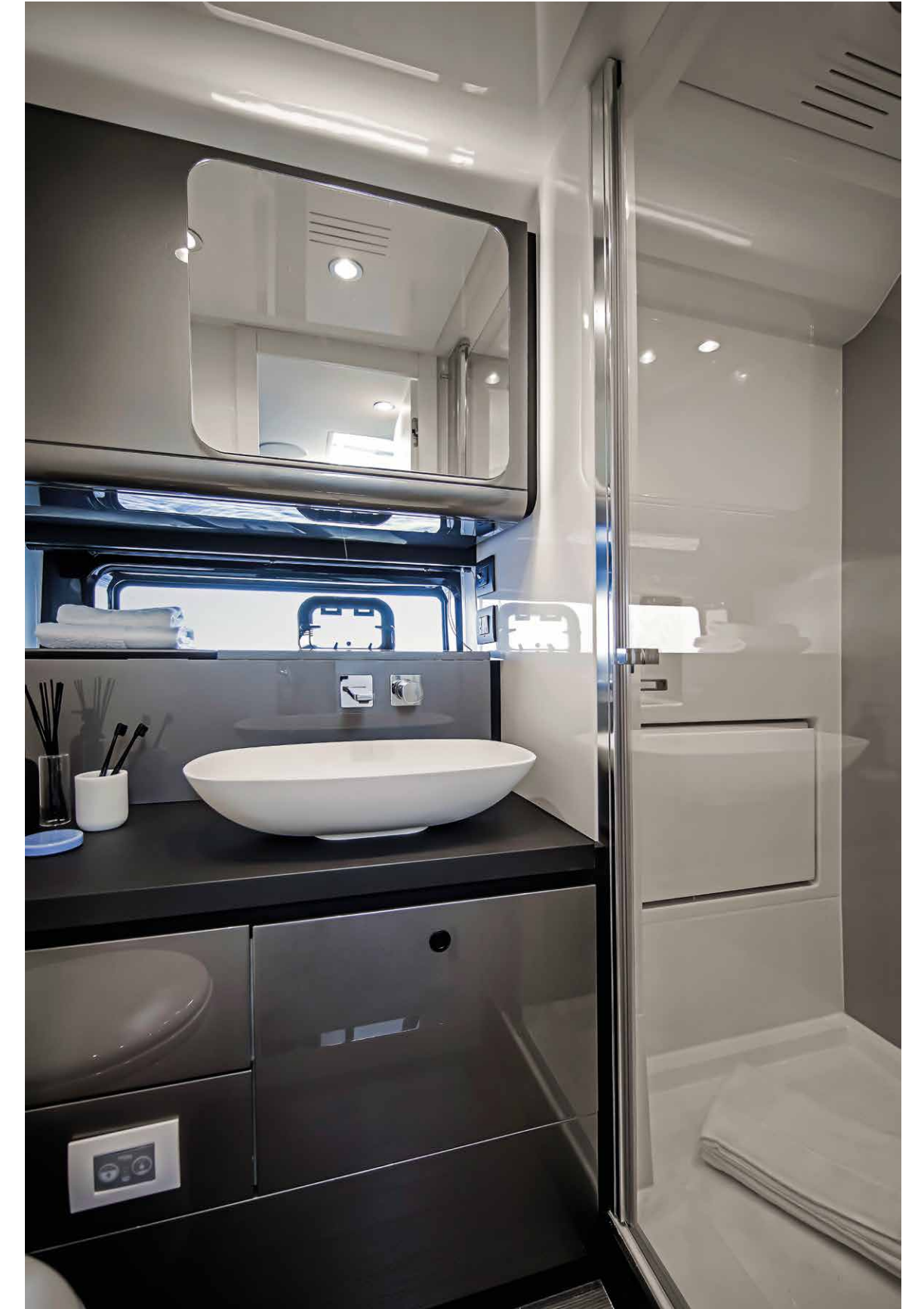

Natural light enters from above and through the side windows of the second cabin to create a pleasant, inviting space. Located towards the stern, it is fitted with twin beds and a separate shower stall.









02

# HER MAIN TECHNICAL FEATURES

The beauty of the Verve 48 is not solely a matter of exterior and interior design elements that combine to perfectly play out Azimut's essence.

Her beauty is also about discovering the technological advancements and special components that contribute to making her truly unique and highly innovative.



# HIGH PERFORMANCE DOUBLE STEPPED HULL

The high-performance patented Stepped 'V' Ventilated Tunnel (SVVT) was developed by Michael Peters and incorporates a classic deep 'V' hull with two transverse steps and a central tunnel aft. It is this latter feature that sets it apart from other current stepped deep 'V's, with its shallow aft central tunnel increasing the longitudinal stability of the boat in high speed turns and adverse situations.

The use of the SVVT hull on the Verve 48 represents the merging of cutting-edge hull forms with advanced outboard engine power and avant-garde concept design and styling. The combination of technologies culminates in a boat that boasts unmatched performance, maneuverability and speed in its class and represents the largest and grandest SVVT pleasure boat available on the market.



# CARBON-TECH GENERATION

Azimut's pioneering use of carbon fiber lamination goes beyond pure performance. The Carbon Tech Generation offers expanded volumes on board, while maintaining excellent dynamic stability and perfect handling. Preserving the yacht's low center of gravity, the carbon fiber was focused on the upper parts of the yacht, lightening the laminated components by up to 30% and reducing the natural roll momentum up to 15%.

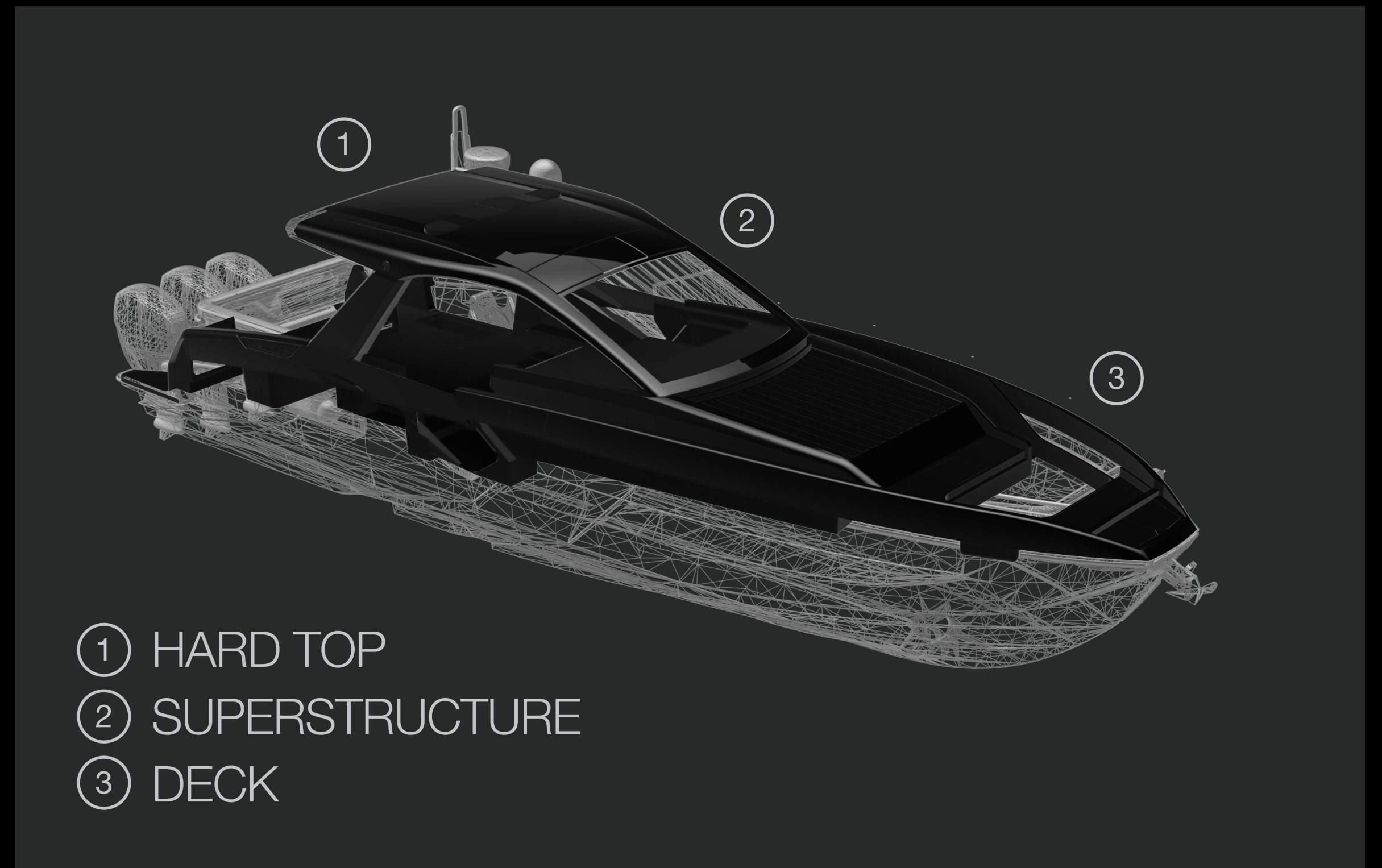

- ① HARD TOP
- ② SUPERSTRUCTURE
- ③ DECK



# INTEGRATED CONTROL AND MONITORING SYSTEM

The custom-installed Raymarine electronics have been integrated to control and monitor every onboard system: from engines and alarms, to bilge and water discharge pumps, tank levels and engine room ventilation, right through to the sound system and the air conditioning units. The system can be accessed onboard from the helm station and, with the mobile app, remotely from a tablet or smartphone.



03

# VERVE 48 SPEC SHEET

# GENERAL CHARACTERISTICS

LENGTH OVERALL	15,03 m	49' 4"
BEAM MAX	4,10 m	13' 5"
DRAFT	1.28 m	4' 3"
DISPLACEMENT	17,8 t	39242 lbs
ENGINES	3 x 600 mHP (440 kW) Verado Mercury	
MAXIMUM SPEED	up to 50 kn	
CRUISING SPEED	37 kn	
KEEL	Stepped planing hull	
FUEL CAPACITY	2340 l	618 US Gls
WATER CAPACITY	300 l	79 US Gls
CABINS	2	
BERTHS	4	
HEAD COMPARTMENTS	1	
BUILDING MATERIAL	GRP + Carbon	
EXTERIOR DESIGNER	Francesco Struglia Design	
INTERIOR DESIGNER	Francesco Struglia Design	
HULL DESIGNER	Michael Peters	
BUILDER	Azimut Yachts	
CERTIFICATIONS	CE A; NMMA	

Last updated 09.2023

Please consult your dealer for the latest specifications.

UNI ISO 8666

The performance described applies to a vessel with standard configuration (standard equipment installed) and a clean hull, propellers, and rudder. It is also noted that the performance described was recorded under favourable sea and wind conditions (Beaufort scale index 1, Douglas scale index 1); different and worse sea conditions could significantly impact performance.

CE MARK

Given the continual evolution of technology, Azimut | Benetti S.p.A reserves the right to modify the technical specifications on its vessels at any time and without prior notice.

# ABOVE VIEW

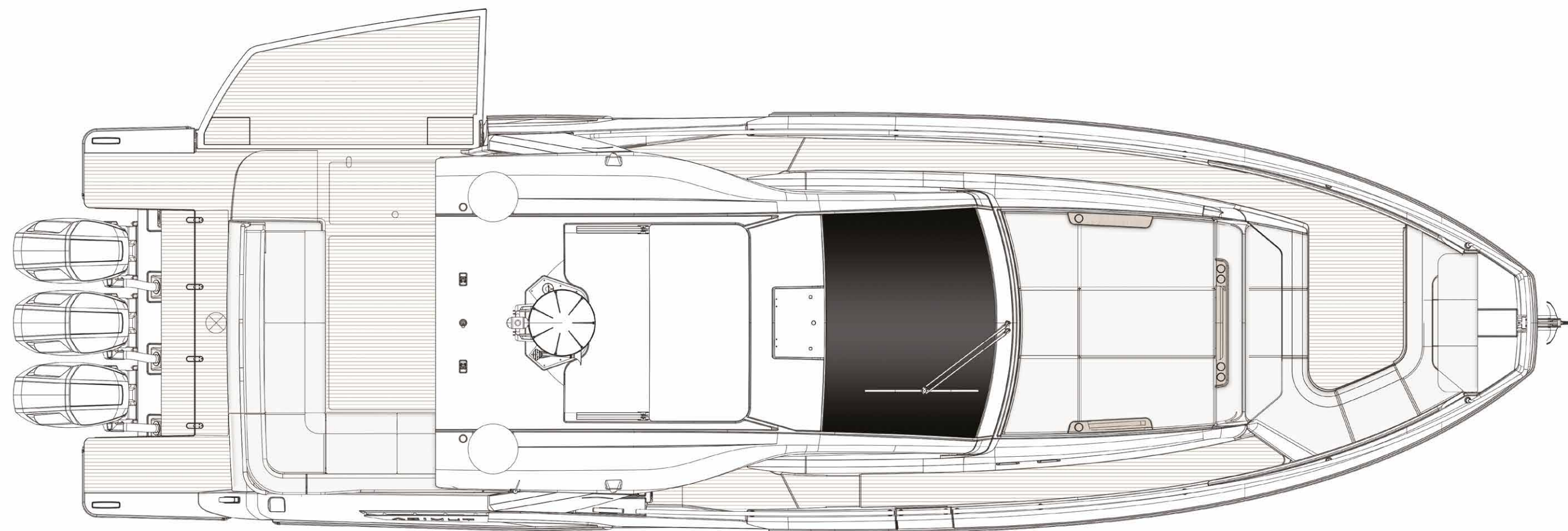



# MAIN DECK

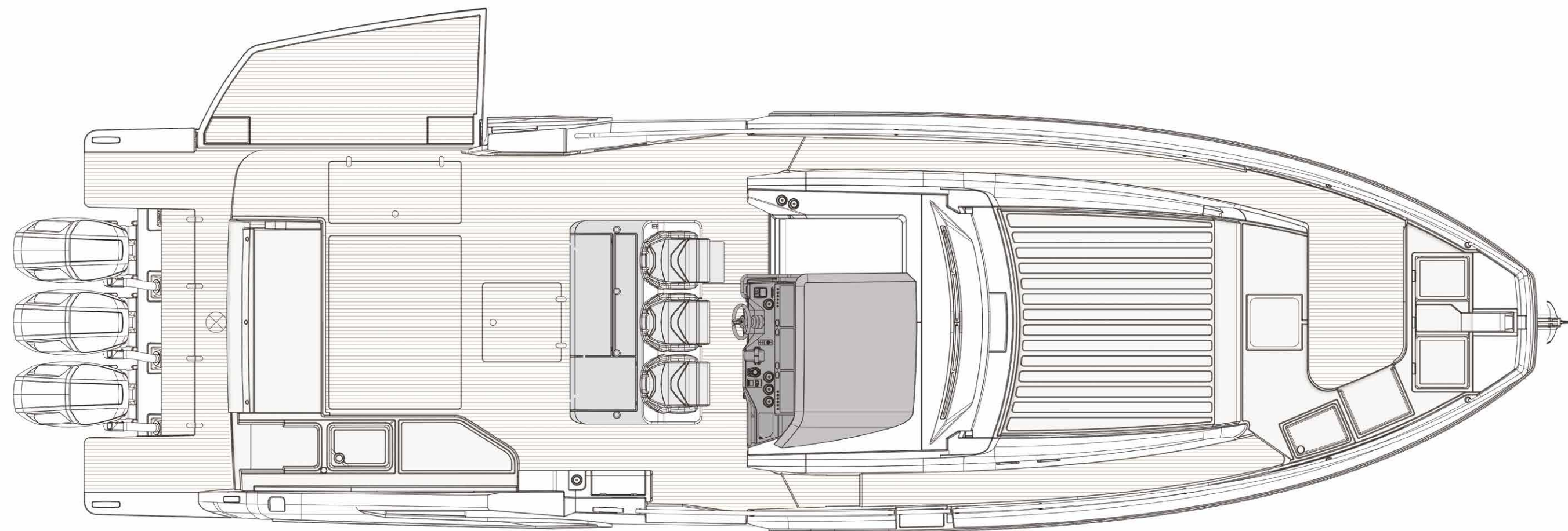

# LOWER DECK

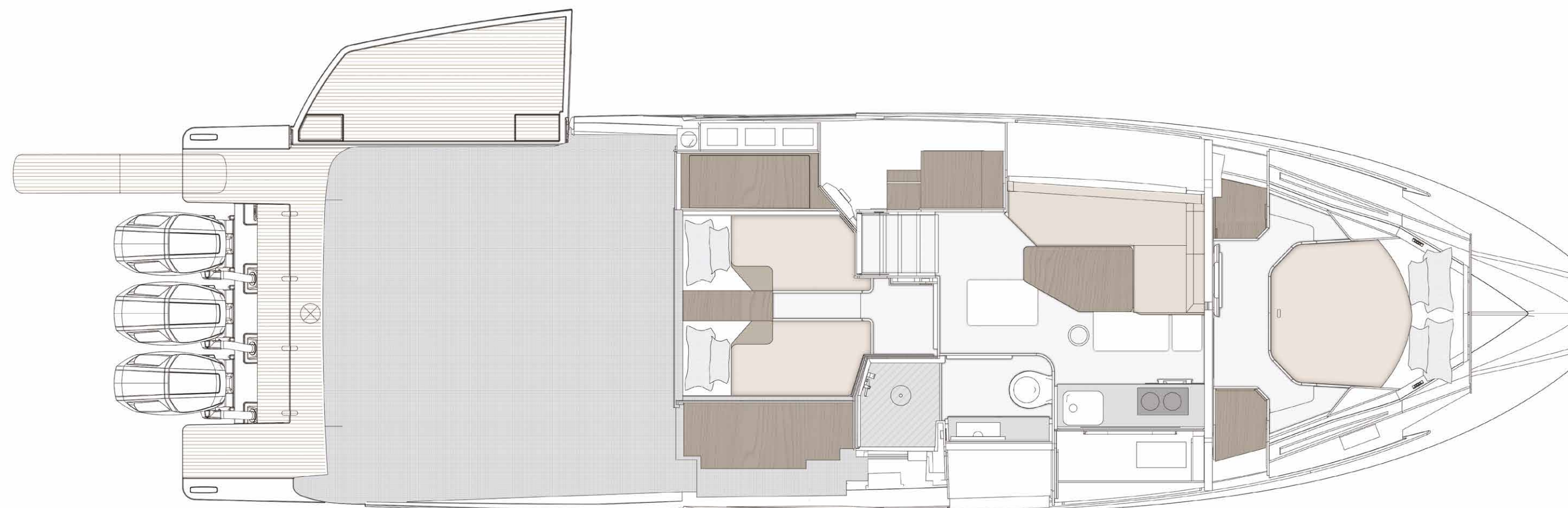

04

# THE VERVE SERIES

# THE WEEKENDER YACHTS

Designed for adrenaline enthusiasts with an appetite for deluxe living, the Azimut Verve Series embodies a new boating sensation, defying the traditional take on American-style outboard yachts and Italian cabin cruisers to launch a one-of-a-kind segment: the weekender. Uninhibited and freedom-loving, her fierce aptitude for performance unexpectedly combines with luxurious onboard ambiances, setting aside all compromise for a thrillingly elevated nautical experience.

Allow yourself to have it all.

42  
48





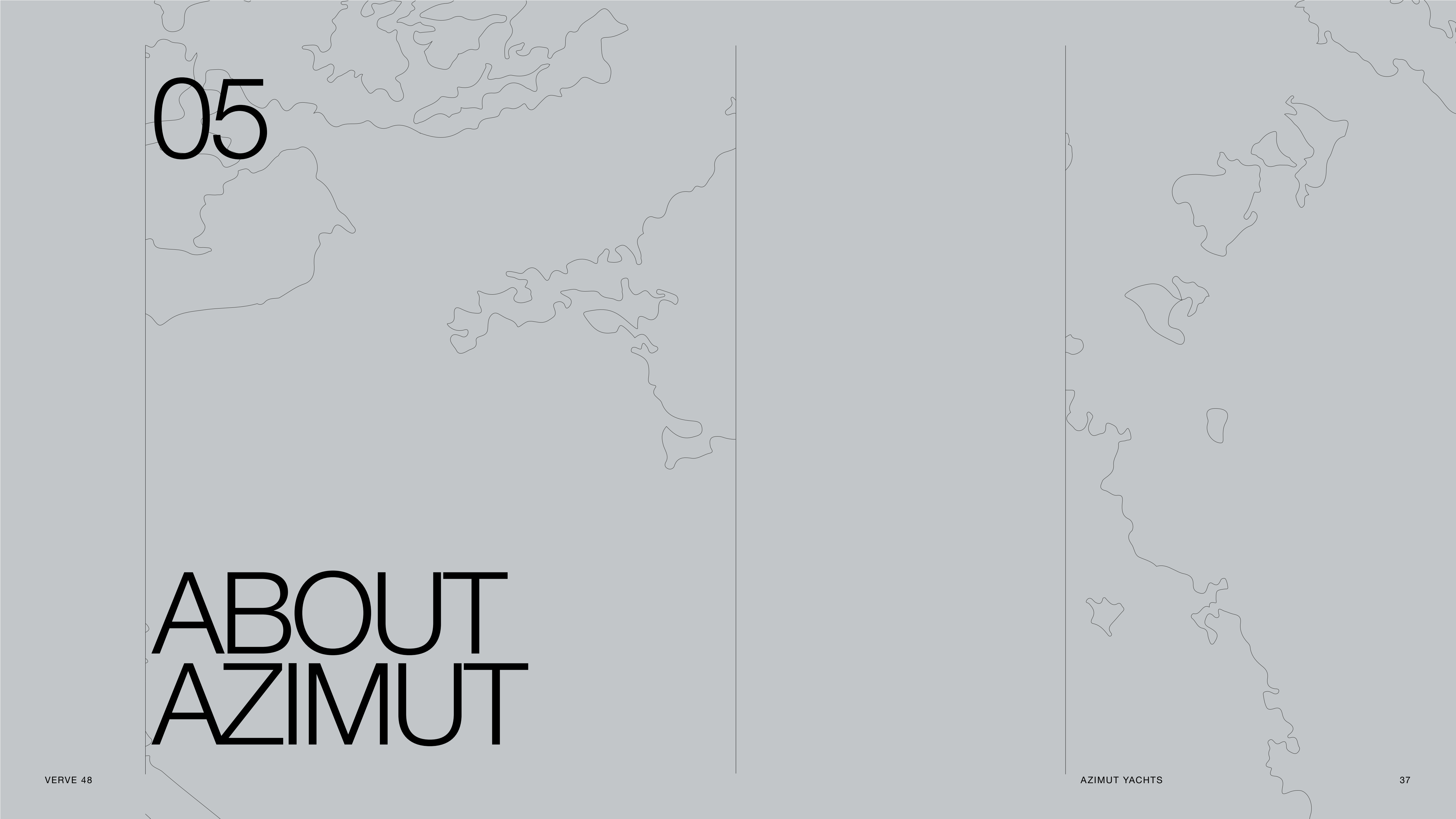

05

# ABOUT AZIMUT





# A FAMILY-MADE COMPANY CULTURE

An immense and personal passion for the sea. A clear and forward-facing attitude. A strong and relentless work ethic. Since 1969, Paolo Vitelli, the creative visionary founder and businessman behind Azimut, has been set on challenging the industry's status quo with a daring desire: bring to life an unexpected nautical experience, through yachts built to combine alluring aesthetics with construction expertise and impeccable technology.

An audacious mindset that has, over time, surprised and captivated the yachting sector, transforming Azimut into a bold and recognizable benchmark, and laying the foundation for the birth of the largest megayacht builder in the world, the Azimut | Benetti Group.

The international and management-based standing of the company today, is deeply nourished by the solid and memorable family heritage that has distinguished it from the beginning. A historically pioneering vision that enables it to continue thriving day after day, through ingenious inventions and long-term goals that look to the future with Paolo's daughter, Giovanna Vitelli.



# A SUSTAINABLE VISION TODAY, FOR TOMORROW

An avant-garde vision and a strong emotional appeal have shaped the history of Azimut as a leader in the field of nautical innovation as well as its commitment to the creation of a sustainable-oriented and attentive company culture today.

An ambitious and personal touch that has allowed Azimut to grow and evolve on both levels, embracing the challenge of a future nurtured by an eco-conscious approach to boat construction and by an authentic focus and responsibility on human well-being.







# OUR ♻️ ECO-YACHTING PHILOSOPHY

The Azimut I Benetti Group has made tangible investments to guide the Technical as well as the R&D departments toward the construction of yachts with a diminished environmental impact. Its main areas of intervention have focused on significantly lowering fuel consumption and CO<sub>2</sub> emissions through the development of highly efficient hull designs, innovative propulsion systems and an extensive use of carbon fiber to decrease yacht weight.





# A SAFE AND HEALTHY WORK ENVIRONMENT

The forerunning shipyard of Avigliana was the first of the company's Italian shipyards to obtain the ISO 45001 certification in 2011, attesting its rigorous abidance to all occupational health and safety requirements. Recognized as the most technologically-advanced shipyard in Europe, it has also led the nautical sector revolution in terms of being among the earliest adopters of the vacuum infusion process to drive resin into a laminate, avoiding styrene emissions and therefore guaranteeing its precious workers a healthier setting.

As of 2013, all the other Italian production sites have adapted to meet the necessary requirements to obtain the ISO 45001 certification.



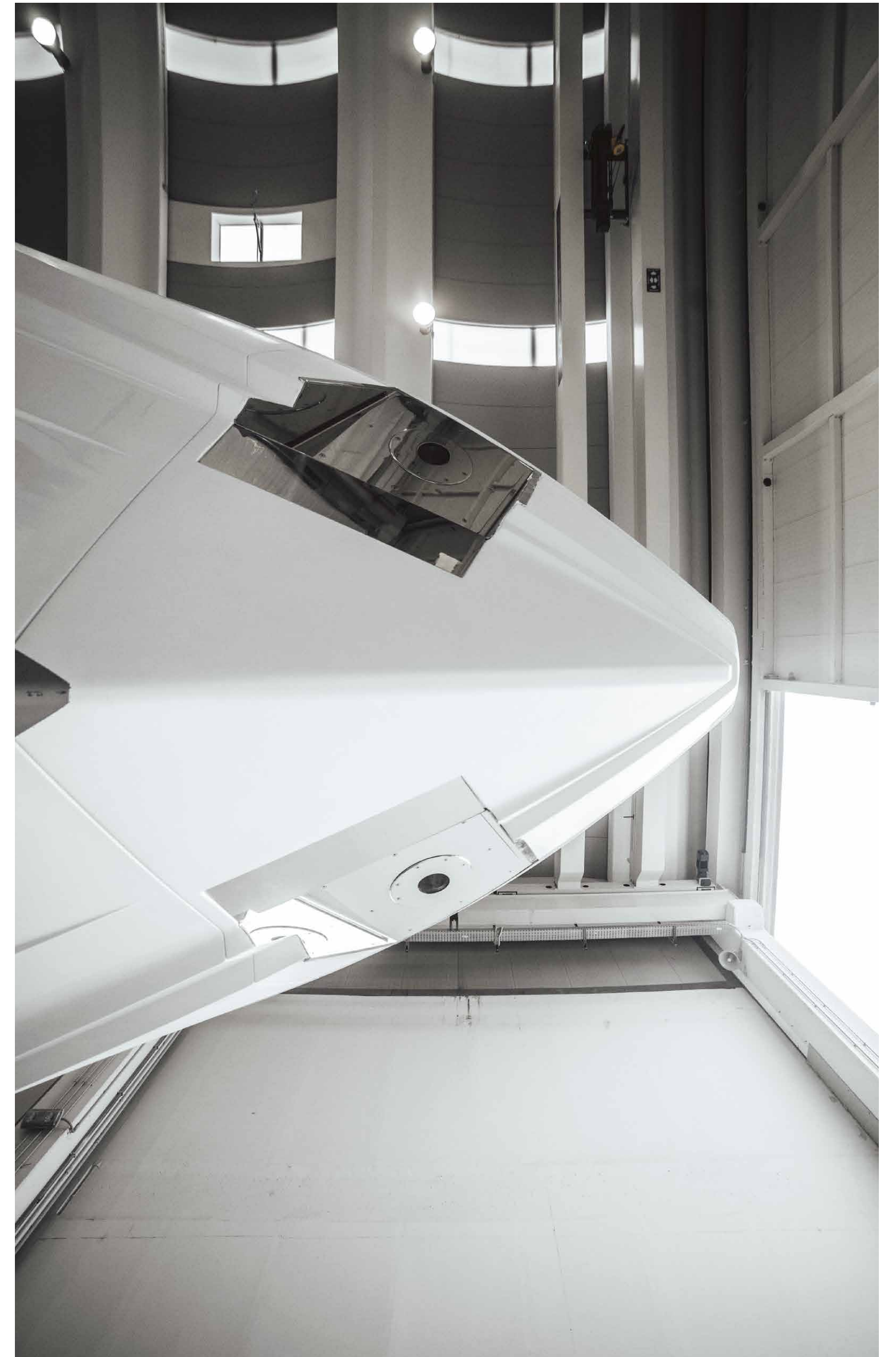



# A GLOBALLY-CONNECTED DEALER AND SERVICE NETWORK

---

5 SHIPYARDS

---

6 DIRECT OFFICES

---

138 OFFICIAL DEALERS

---

80 COUNTRIES

---

The highly widespread commercial network put in place by Azimut Yachts, allows the company to offer a continuous presence to its ship owners, concretely curating their demands by meeting their most specific needs.

[Find your Dealer →](#)





# THE LARGEST PRIVATE GROUP IN THE YACHTING WORLD

Azimut is part of the Azimut | Benetti Group, the biggest private player and shipbuilder in the nautical sector today. The Vitelli family, the founder and majority shareholder of the company, has been leading the way for over fifty years now, continuing to innovate through the Group's main yacht brands, Azimut and Benetti, while developing a variety of service brands to cater to the different demands of ship owners worldwide.





# OUR SHIPYARDS MAKE US PROUD

Avigliana — Italy

HQ / SHIPYARD

Savona — Italy

DELIVERY CENTRE

Viareggio — Italy

SHIPYARD / STYLING LOUNGE

Fano — Italy

SHIPYARD

Itajaí — Brazil

SHIPYARD

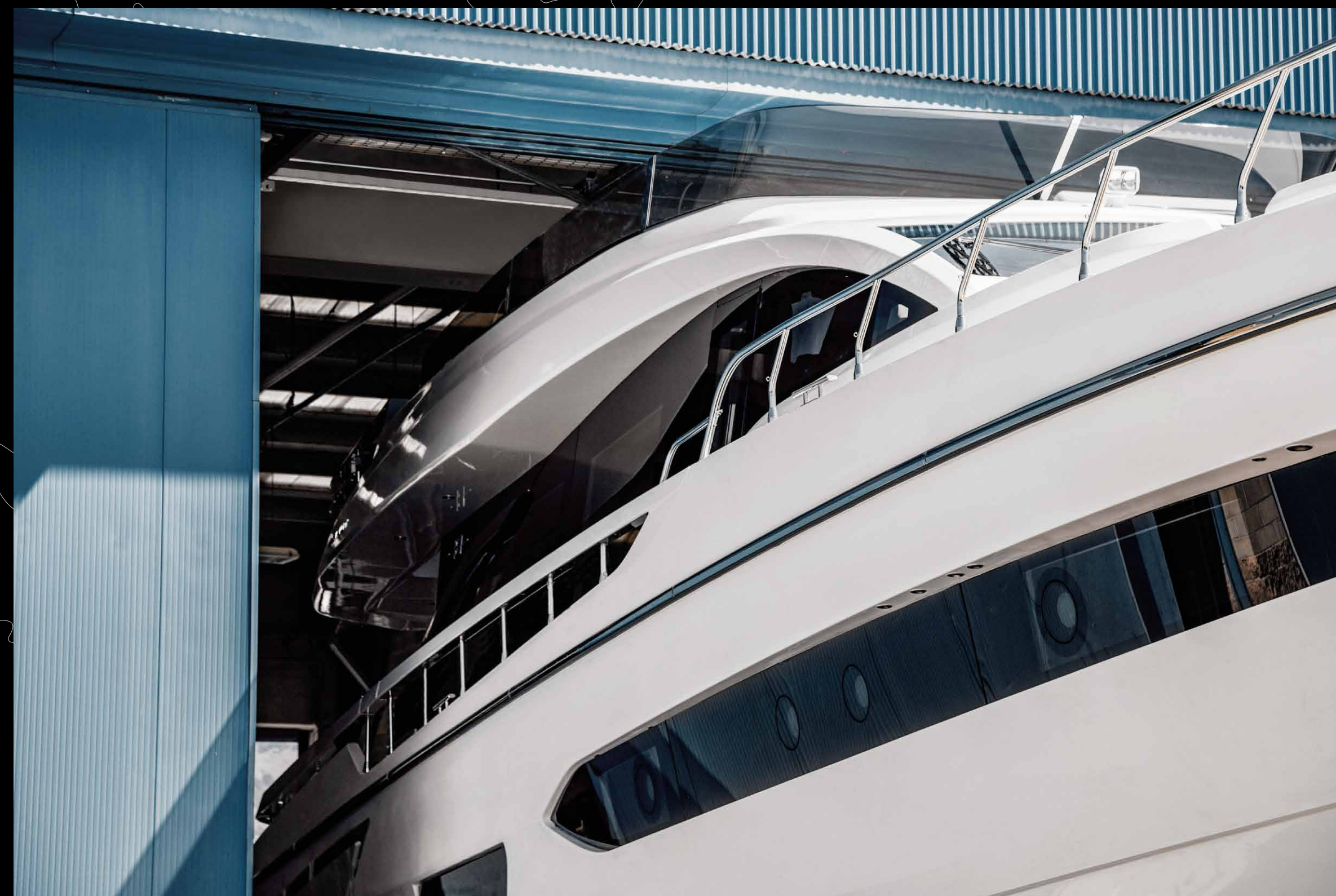





CONCEPT & DESIGN: APART  
PHOTOS: ALESSANDRO GUERRIERI

AZIMUT YACHTS THANKS: APR LUXURY LINEN, DEDAR

OFFICIAL PARTNER



GARMIN.

Raymarine



VOLVO  
PENTA

AZIMUT | BENETTI SPA  
VIA MARTIN LUTHER KING, 9  
10051 AVIGLIANA, TORINO  
ITALY

RELEASE 09.23

This brochure in no way constitutes a contract of sale for the boatyard's vessels to any person or company. All information contained herein, including but not limited to technical and performance data, illustrations, and drawings, is non-binding and for purposes of illustration only. The information in this brochure refers to the boatyard's standard motoryacht models available as of the date of publication. Technical and descriptive information is valid only to the extent that it pertains to the specific vessel that is the subject of a purchase. Contract terms are valid only to the extent that they are contained in a contract of sale. This document is based on information available at the time of publication. Despite efforts to ensure the greatest possible accuracy, the information contained herein may fail to cover all details, omit technical or commercial changes that may have been made subsequent to publication, describe features that are not present, and fail to envisage all circumstances that might occur. Any illustrations, photographs, diagrams and examples shown in this brochure are included solely for the purposes of illustrating the text. Due to the different features of each vessel, the boatyard assumes no liability for actual use based on the illustrated applications.



AZIMUT

[azimutyachts.com](http://azimutyachts.com)

