

**Cetera** 60'



# Cetera 60'

## Main Data

Shipyard **Cetera**  
 Naval Architect **Francesco Guida**  
 Exterior Design **Guida Design + Engineering**  
 Interior Design **Guida Design + Engineering**

### CLASSIFICATION

The Yacht has been designed and will be built complying with RINA regulations and in compliance with the EU provisions 94/25/CE, as amendment EU provisions 2003/44/CE. The certificate issued is the EU declaration of conformity in regards to plan category B module B. Cetera 60 is rated for a max. capacity of 12 people.

### KEY FACTORS

- Sea Level Beach Club Style Cockpit
- Double height skylighted Main Lobby (connecting two Decks)
- Owner + Guest cabins w/full height panoramic windows
- Silent Main Deck
- Fore Main Deck Cockpit for living and dining
- Openable Upper Deck w/american style galley and unexpected Dining Area for 8
- Crew Quarter spaces comparable to larger category of yachts
- Huge Technical Compartments + Storage

### MAIN DATA

Model .....	Cetera 60
Type .....	Motor Yacht
Hull .....	Planing Hull
Hull Construction .....	GRP
Main Deck Construction .....	GRP
Overall Length .....	18.28m/60ft
Waterline Length .....	15.74m/51.64ft
Maximum Beam .....	5.48m/18ft
Maximum Draft .....	1.30m/4.27ft
Displacement .....	27t
Fuel .....	1.500l
Fresh Water .....	600l
Grey Water .....	280l
Black Water .....	280l
Main engines .....	n.2 Volvo Penta IPS 700
Cruise speed .....	20knots
Maximum speed .....	23knots
Generator .....	13,5 kW 50 Hz KOHLER
Air conditioning .....	60.000 BTU/H
Electrohydraulic tender Davit .....	500 Kg/1.100 lbs
Electrohydraulic gangway .....	2.55m/8.37ft
Accommodation .....	3 cabins+3 bathrooms+crew

### LAYOUT

- Lower Deck**
- Engine Room
  - Hydraulic System
  - Tanks + Storage
  - Electrical System
  - Crew Accomodation for 2
  - Crew Bathroom + separate Shower
  - Generator
  - Chain Locker
- Main Deck**
- Retractable Bathing Platform
  - Tender Garage
  - Covertible Cockpit Beach Club Style
  - Double height Skylighted Main Lobby
  - Vip Cabin w/ bathroom and separate shower
  - Guest cabin w/twin beds, bathroom and separate shower
  - Owner's suite w/bathroom and separate shower
  - Panoramic Living Area with bar corner and direct access to the external Fore Living Area
  - Main Deck Cockpit on forward al fresco Living and Dining Area
- Upper Deck**
- Convertible Living into comfortable Dining Area for 8 guests
  - Wide american style galley
  - Wheelhouse Area w/double ergonomic pilot seats and companion panoramic chaise longue

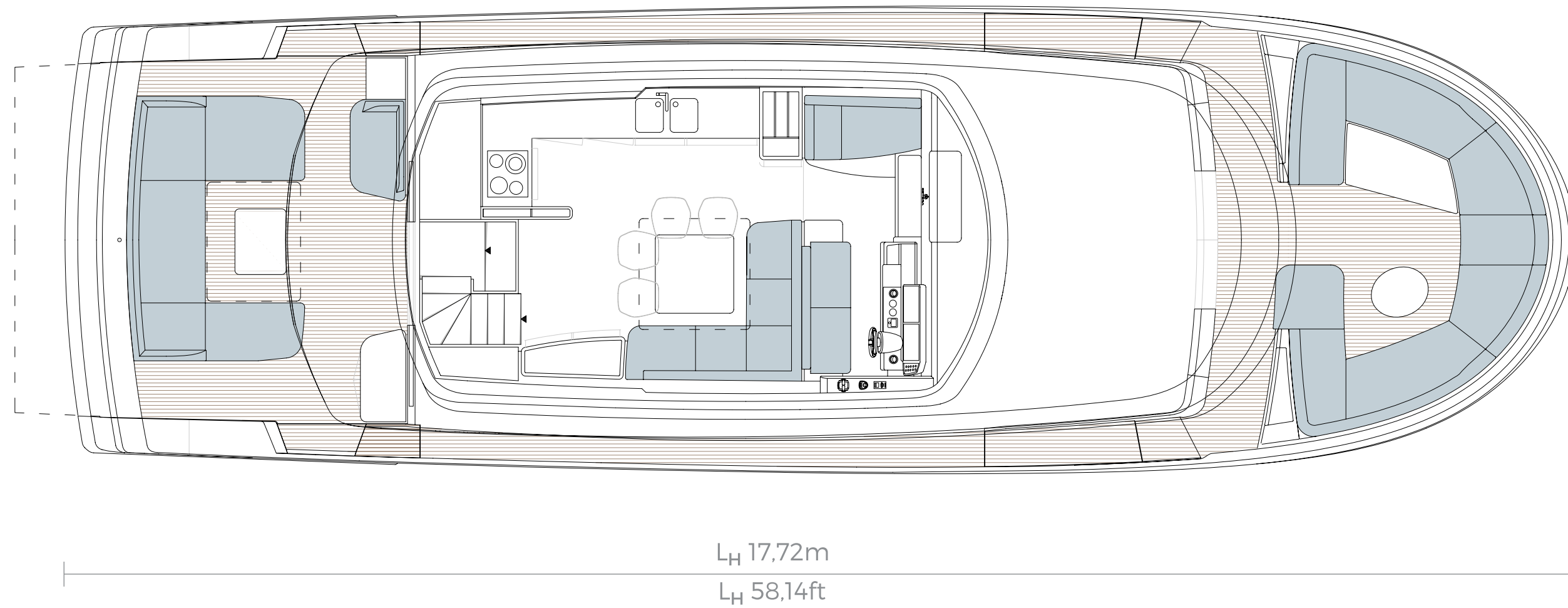

# Upper Deck

General arrangement

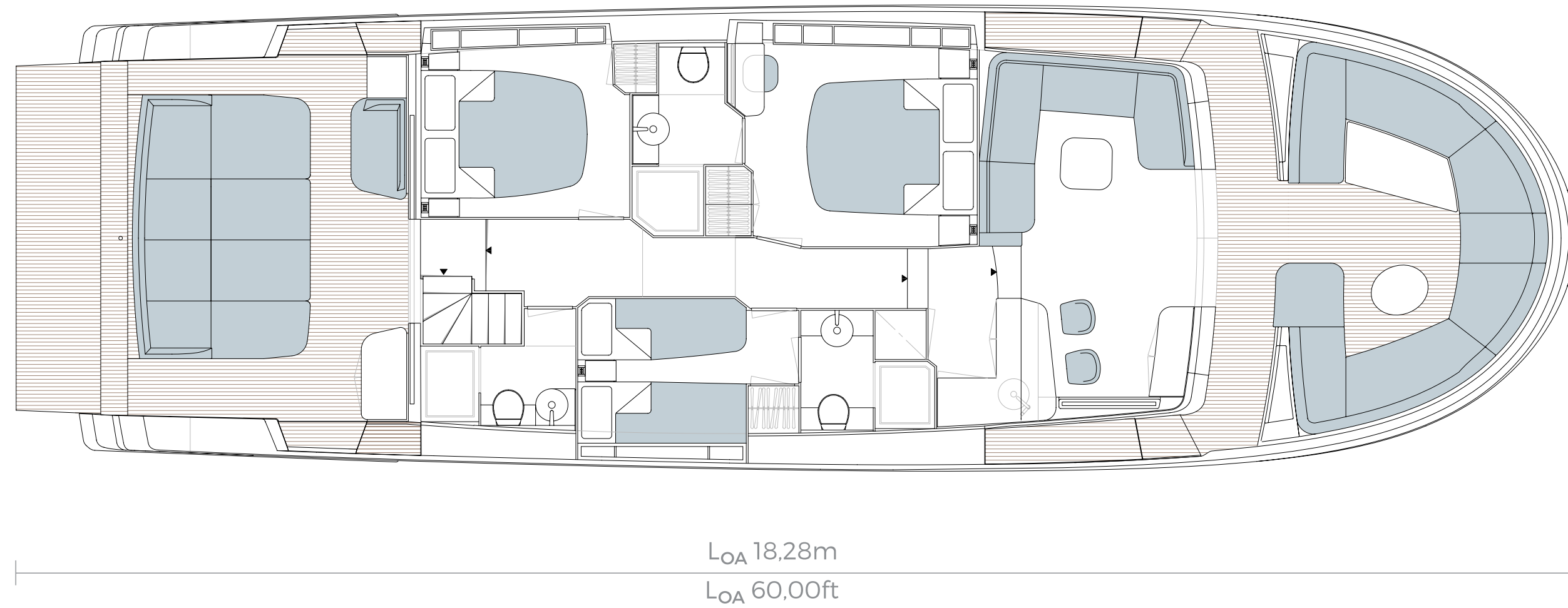

# Main Deck

General arrangement

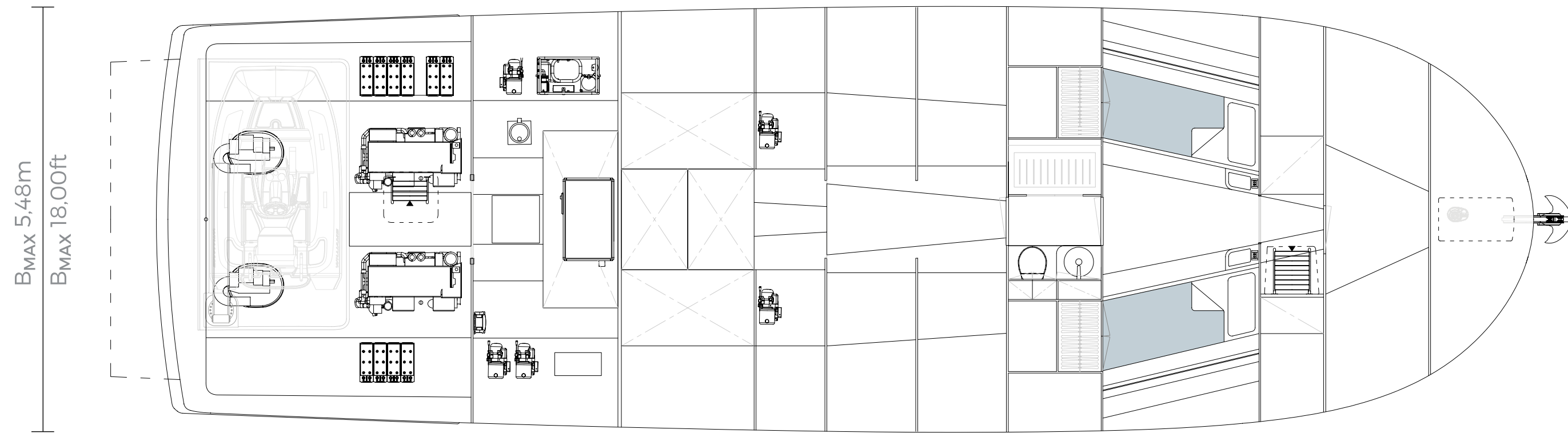

# Lower Deck

General arrangement









































































